

9 DIRECTION ENERGY PLATE SET

ENERGY BALANCING



Four Major, Four Cardinal, and One Center Direction have a specific function to perform when a dynamic web of energy circulates inside the built environment.

During such a process, if any direction gets a defect, we need to rectify the particular energy plates which can be also called **Vastuworld Dikbandhan (Shielding & Tying all the Direction)**.

9 Direction Plates works to enhance directional energy fields.

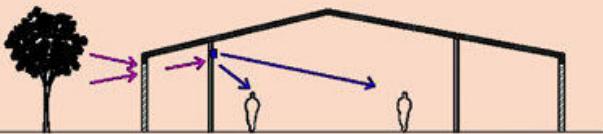

Installed on a specific position on the wall of each **directional zone** of house, office or any space after performing rectification on **Cosmic Energy Level**.

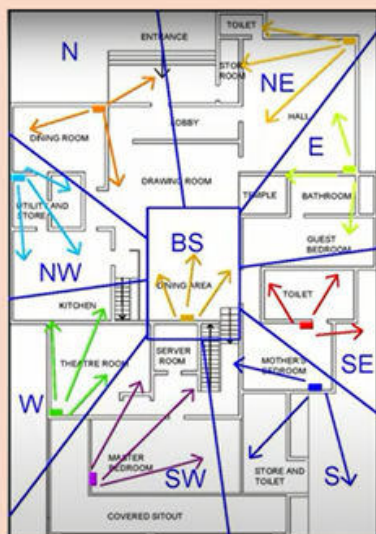

Brahmasthan Energy Plate (Center)

Elements considered by Vedic strong energies of God Brahma



East Direction Energy Plate:

Elements considered by Vedic strong energies of God Indra

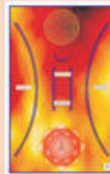

South-East Direction Energy Plate:

Elements considered by Vedic strong energies of God Agni (Fire Zone)

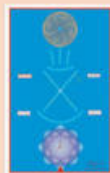

South Direction Energy Plate:

Elements considered by Vedic strong energies of God Yama

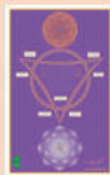

South-West Direction Energy Plate:

Elements considered by Vedic strong energies of God Nirriti (Earth Zone)



West Direction Energy Plate:

Elements considered by Vedic strong energies of God Varun

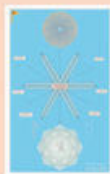

North-West Direction Energy Plate:

Elements considered by Vedic strong energies of God Vayu (Air Zone)



North Direction Energy Plate:

Elements considered by Vedic strong energies of God Kubera



North-East Direction Energy Plate:

Elements considered by Vedic strong energies of God Soma (Water Zone)

Note: Detailed description regarding the product and installation is given in the manual.

For more information contact - +91 9822573102, www.vastuworld.com